

There are three common types of quality control material; lyophilised (freeze dried), liquid ready-to-use and liquid frozen. Each format will have its own advantages and disadvantages but most importantly each type will have different storage requirements and need to be handled differently. This guide explains the different methods for preparing each type of control.

Preparing Lyophilised / Freeze Dried Controls

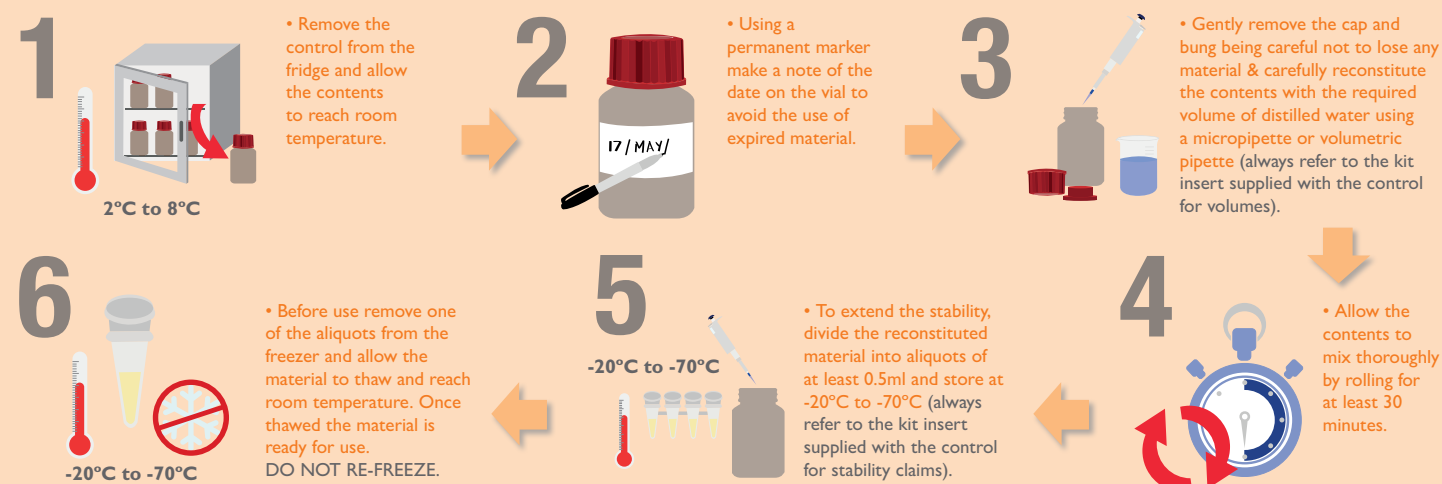

Guide to using a micropipette

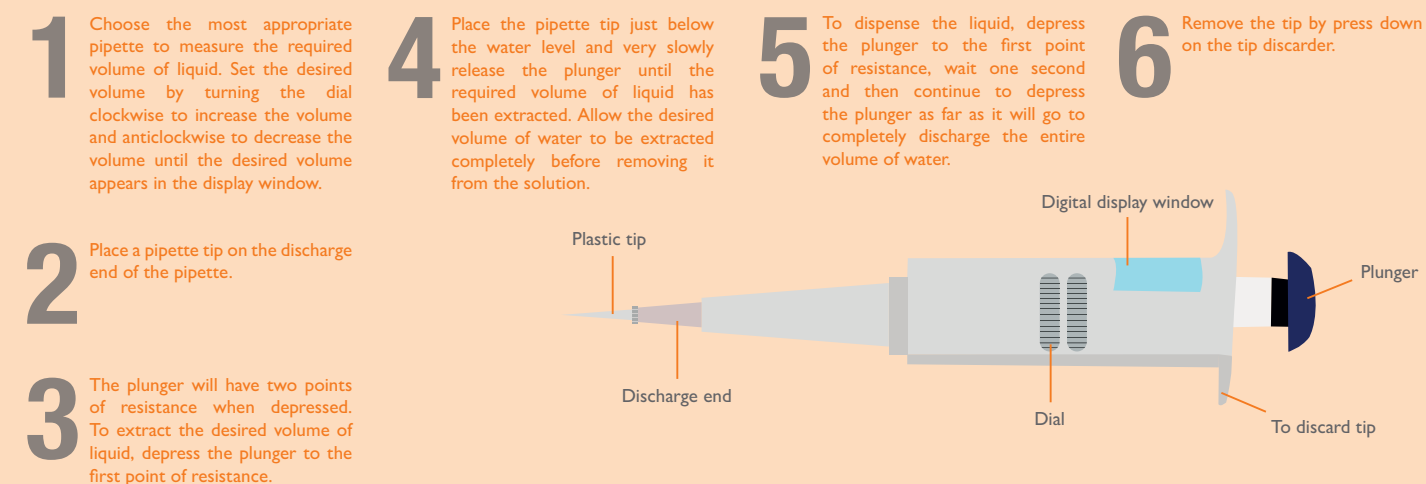

Preparing Liquid Ready-To-Use Controls



Preparing Liquid Frozen Controls

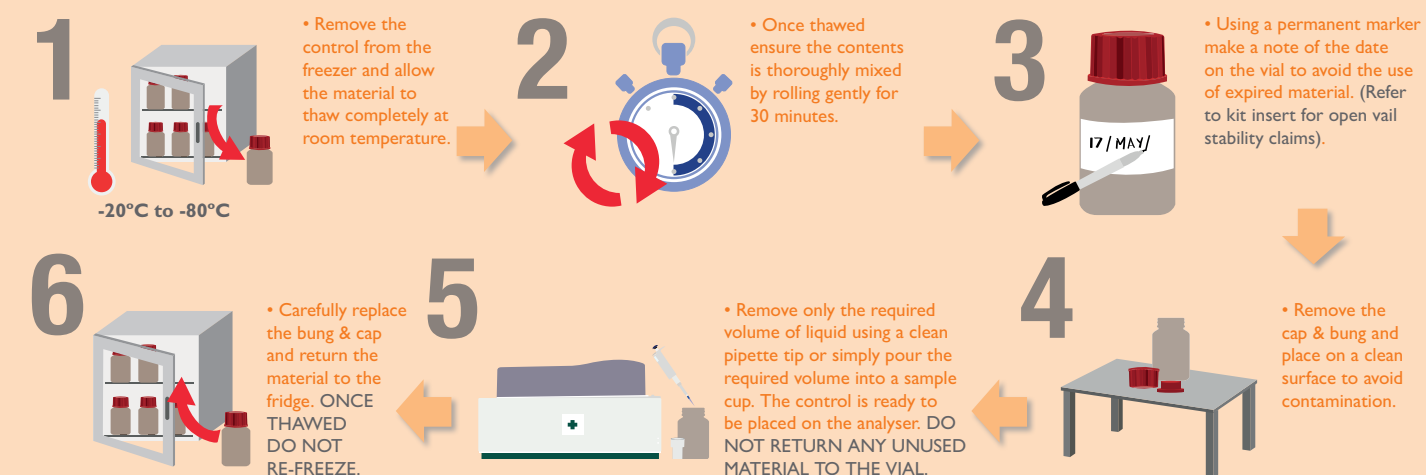

*Please note the information provided is designed to be used as a guide only, always follow the manufacturer's instructions.